

## Mini Indoor LED Remote Head

### FEATURES

- Long lasting, efficient, ultra bright white LED lamp heads.
- One, 0.5W white LED per lamp head.
- Unique all-inclusive lamp, diffuser and lens assembly.
- Adjustable LED lamp heads provide optimal center-to-center spacing.
- Powered from low voltage power source with low voltage wiring (not provided).

PROJECT:

TYPE:

CATALOG #:

**PATHLITE**  
**Series MRH**  
REV #: MRH.11.25.03



### MOUNTING

- Universal mounting adapter plate included with mounting hardware.
- Distance of maximum run is determined by system voltage, wire gauge and total maximum wattage on the run.
- Suitable for wall or ceiling mount.
- Injection-molded, engineering grade, 5VA flame retardant, high-impact resistant, thermoplastic in white or black finish.



### FIXTURE COMPATIBILITY TABLE

Refer to individual specification sheets to confirm remote load capacity.

EBU & EXIT MODELS			
EML	ELP	RHO	CLP
CXT	RMC	CWL	HLC
CENTRAL BATTERY MODELS			
CBM	CBL	CBE	

### DIMENSIONS

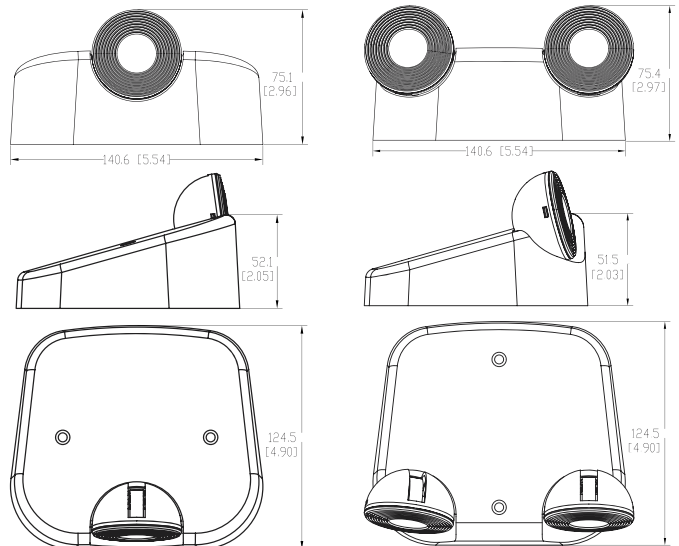

### CODES

- Meets UL924, NFPA 101 Life Safety Code, NEC, OSHA, Local and State Codes.

### WARRANTY

- 5 year total customer satisfaction warranty.  
For details see Signtex product catalog technical data section.

### FIXTURE ORDERING INFORMATION EXAMPLE: MRHRB2B

SERIES	OPERATION	LAMP HEADS	HOUSING COLOR	OPTIONS
MRH	RB Powered from EBU or EXIT Combo RE Powered from Central Battery System	1 Single Head 2 Double Head	(Blank) White B Black	(Blank) 0.5W per head